

1,450 sq.ft. UNITS 5&6 - Tower A

Unit Plan



Type	Built-up Area			Common Area		Total Built-up Area		Dwelling Units	Tower			
	Sq. ft.	%	External Wall Area	Sq. ft.	%	Sq. ft.	%					
3BHK + 2T	900.95	62.13	101.18	6.98	160.06	11.04	287.81	19.85	1450	100	64	A&D

Loading = 19.85%

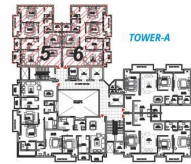

KEY PLAN



3D illustration of Standard Apartment

S. No.	Room Area	Length		Width	
		M	M	M	M
1.	Living	3.15	4.50		
2.	Dining	3.60	3.415		
3.	Kitchen	2.10	3.30		
4.	Bedroom 2	3.00	3.30		
5.	Toilet	2.40	1.50		
6.	M. Bedroom	3.15	4.50		
7.	M. Toilet	2.40	1.50		
8.	Bedroom 3	2.885	3.30		
9.	Balcony	1.50 WIDE			
10.	Utility	1.20 WIDE			
11.	Balcony	1.50 WIDE			

Note: 1 Meter = 3.28 feet